

## \$723,697

### LOT 23

Land Size: 446m<sup>2</sup>  
Frontage: 12.82m  
Depth: 23m





## SERENA 22

4 2 2



## SERENA 22

 4  2  2

### INCLUSION LIST:

- Light-filled interiors
- Caesarstone benchtop to Kitchen island bench
- Selection of ceramic and porcelain floor tiles
- Artusi appliances
- Methven & Phoenix tapware
- Semi-inset vanity basins
- 2590mm high ceilings
- LEDs throughout
- Flyscreens to window locks and all openable windows
- Dulux Professional Series paint to internal walls
- Colorbond fascia, gutters and downpipes

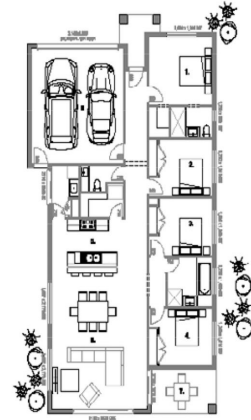

The peak of modern living.  
[ALIRABERWICK.COM.AU](http://ALIRABERWICK.COM.AU)

WHILE BEST ENDEAVOURS HAVE BEEN USED TO PROVIDE INFORMATION IN THIS PUBLICATION THAT IS TRUE AND ACCURATE, ALIRA, ITS CONSULTANTS, AGENTS AND RELATED ENTITIES ACCEPT NO RESPONSIBILITY AND DISCLAIM ALL LIABILITY IN RESPECT TO ANY ERRORS OR INACCURACIES IT MAY CONTAIN. PROSPECTIVE PURCHASERS SHOULD MAKE THEIR OWN ENQUIRIES TO VERIFY THE INFORMATION CONTAINED HEREIN.